

DATE: 12/16/2019 9:45:42 AM
 RW:0002000-1002292-05 Dwg:V0 DGN:PHASE 2 Subproj:ref 2 Sheets:2292_FHZ_SIGN07.dgn

- NOTE:**
- EXISTING SPECIAL GUIDE/INFORMATION SIGNS, METRO SIGNS AND OTHER PUBLIC/PRIVATE ENTITY SIGNS ARE NOT SHOWN IN THESE PROPOSED SIGNING AND PAVEMENT MARKING DRAWINGS. HOWEVER, THOSE SIGNS, POSTS, AND HARDWARE SHALL BE PROTECTED/SALVAGED DURING CONSTRUCTION AND/OR REMOVED AND RELOCATED/RE-INSTALLED AT OR NEAR THE ORIGINAL LOCATION AFTER THE PAVEMENT CONSTRUCTION IS COMPLETE. NO SEPARATE PAYMENT WILL BE MADE FOR THIS WORK, WHICH INVOLVES NEW FOUNDATION.
 - REPLACE AND INSTALL NEW SIGNS AS SHOWN IN THESE PROPOSED SIGNING AND PAVEMENT MARKING DRAWINGS. INCLUDE NEW POSTS, HARDWARE AND NEW FOUNDATION.
 - FOR GENERAL PAVEMENT MARKING NOTES SEE GENERAL NOTES AND LEGENDS SHEET 266. (CITY OF HOUSTON STANDARD DWG NO: 01510-01)
 - FOR HORIZONTAL ALIGNMENT DATA, SEE GEOMETRIC DATA SUMMARY. PAVEMENT CALLOUTS ARE TO FACE OF CURB UNLESS NOTED OTHERWISE.
 - PAVEMENT MARKINGS AND SIGNING SHALL BE INSTALLED IN ACCORDANCE WITH CITY OF HOUSTON (COH) TRAFFIC MANAGEMENT AND MAINTENANCE DIVISION'S PAVEMENT MARKINGS AND SIGNING DETAILS (3700 SERIES), TMTCD STANDARDS AND SPECIFICATIONS. PERMANENT PAVEMENT MARKINGS SHALL BE THERMOPLASTIC MATERIAL PER THE CITY OF HOUSTON SPECIFICATIONS.
 - MATCH CROSS STREET PAVEMENT MARKINGS AND SIGNING UNLESS NOTED OTHERWISE.
 - THE LOCATION OF THE SIGNS AS SHOWN ON THESE PLANS IS APPROXIMATE. IF THERE IS ANY CONFLICT WITH UTILITIES, DRAINAGE ELEMENTS, POWER OR STREET LIGHT POLES OR ANY OTHER PHYSICAL FEATURES, THE NEW SIGN LOCATION WILL BE AS DIRECTED BY THE ENGINEER.
 - SEE CITY OF HOUSTON STANDARDS DWG NO: 01509-01 TO DWG NO: 01509-06 TYPICAL DIMENSIONS AND DETAILS.
 - REFER COH STANDARD DWG NO: 01510-05 FOR STRIPING DETAILS (SHEET 266A).

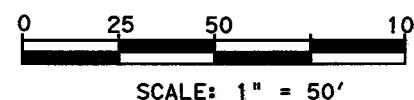

LEGEND

- ➔ DIRECTION OF TRAFFIC/TRAVEL LANE
- SMALL SIGN
- LARGE SIGN
- (A) RAIS REFL PAV MRKR (DOUBLE-SIDED) (TY II-A-A)
- (B) THERMOPLAST PAV MRK (W) (24") (SLD) (STOP BAR)
- (C) THERMOPLAST PAV MRK (Y) (4") (SLD)
- (D) THERMOPLAST PAV MRK (W) (4") (BRK)
- (E) THERMOPLAST PAV MRK (Y) (4") (BRK)
- (F) RAIS REFL PAV MRKR (TY I-C)

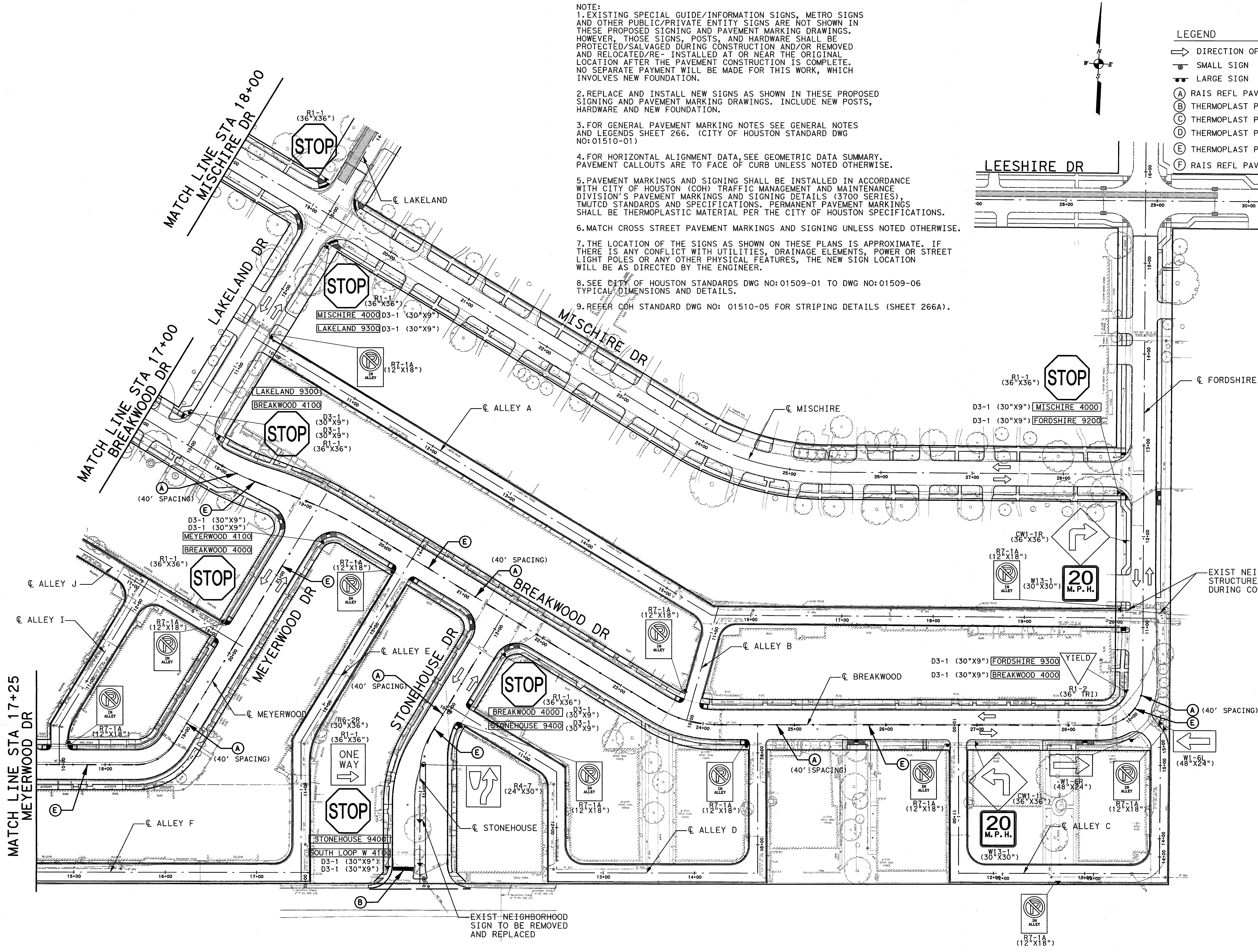

EXIST NEIGHBORHOOD STRUCTURE/SIGNS TO BE PROTECTED DURING CONSTRUCTION

EXIST NEIGHBORHOOD SIGN TO BE REMOVED AND REPLACED

PCAL
 TYPE REG NO. F-2742
 3131 BRIARPARK, SUITE 200
 Houston, Texas 77042
 Phone (713) 822-1444
 Fax (713) 968-9333

STATE OF TEXAS
 COSTAS K. GEORGIADIS
 58295
 LICENSED PROFESSIONAL ENGINEER

SURVEYED BY: LANDTECH INC P-5576
 FB NO.

CITY OF HOUSTON
 HOUSTON PUBLIC WORKS

WOODSHIRE DRAINAGE AND PAVING IMPROVEMENTS SUBPROJECT 2

SIGNING AND PAVEMENT MARKING LAYOUT SHEET 3 OF 4

WBS NUMBER	FOR CITY OF HOUSTON USE ONLY
M-410001-0002-4	65779
DRAWING SCALE	
1"=50'	
CITY OF HOUSTON PM	
TIM VU, P.E.	
SHEET NO. 197 OF 355	

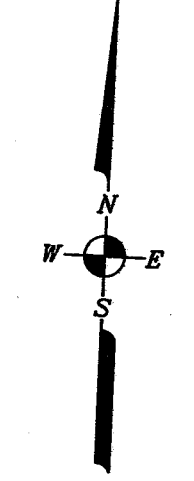
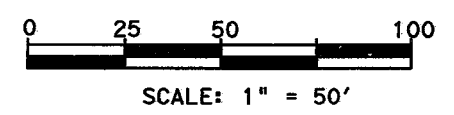

- LEGEND**
- ➔ DIRECTION OF TRAFFIC/TRAVEL LANE
 - SMALL SIGN
 - LARGE SIGN
 - Ⓐ RAIS REFL PAV MRKR (DOUBLE-SIDED) (TY II-A-A)
 - Ⓑ THERMOPLAST PAV MRK (W) (24") (SLD) (STOP BAR)
 - Ⓒ THERMOPLAST PAV MRK (Y) (4") (SLD)
 - Ⓓ THERMOPLAST PAV MRK (W) (4") (BRK)
 - Ⓔ THERMOPLAST PAV MRK (Y) (4") (BRK)
 - Ⓕ RAIS REFL PAV MRKR (TY I-C)

- NOTE:**
1. EXISTING SPECIAL GUIDE/INFORMATION SIGNS, METRO SIGNS AND OTHER PUBLIC/PRIVATE ENTITY SIGNS ARE NOT SHOWN IN THESE PROPOSED SIGNING AND PAVEMENT MARKING DRAWINGS. HOWEVER, THOSE SIGNS, POSTS, AND HARDWARE SHALL BE PROTECTED/SALVAGED DURING CONSTRUCTION AND/OR REMOVED AND RELOCATED/RE-INSTALLED AT OR NEAR THE ORIGINAL LOCATION AFTER THE PAVEMENT CONSTRUCTION IS COMPLETE. NO SEPARATE PAYMENT WILL BE MADE FOR THIS WORK, WHICH INVOLVES NEW FOUNDATION.
 2. REPLACE AND INSTALL NEW SIGNS AS SHOWN IN THESE PROPOSED SIGNING AND PAVEMENT MARKING DRAWINGS. INCLUDE NEW POSTS, HARDWARE AND NEW FOUNDATION.
 3. FOR GENERAL PAVEMENT MARKING NOTES SEE GENERAL NOTES AND LEGENDS SHEET 266. (CITY OF HOUSTON STANDARD DWG NO: 01510-01)
 4. FOR HORIZONTAL ALIGNMENT DATA, SEE GEOMETRIC DATA SUMMARY. PAVEMENT CALLOUTS ARE TO FACE OF CURB UNLESS NOTED OTHERWISE.
 5. PAVEMENT MARKINGS AND SIGNING SHALL BE INSTALLED IN ACCORDANCE WITH CITY OF HOUSTON (COH) TRAFFIC MANAGEMENT AND MAINTENANCE DIVISION'S PAVEMENT MARKINGS AND SIGNING DETAILS (3700 SERIES), TMUTCD STANDARDS AND SPECIFICATIONS. PERMANENT PAVEMENT MARKINGS SHALL BE THERMOPLASTIC MATERIAL PER THE CITY OF HOUSTON SPECIFICATIONS.
 6. MATCH CROSS STREET PAVEMENT MARKINGS AND SIGNING UNLESS NOTED OTHERWISE.
 7. THE LOCATION OF THE SIGNS AS SHOWN ON THESE PLANS IS APPROXIMATE. IF THERE IS ANY CONFLICT WITH UTILITIES, DRAINAGE ELEMENTS, POWER OR STREET LIGHT POLES OR ANY OTHER PHYSICAL FEATURES, THE NEW SIGN LOCATION WILL BE AS DIRECTED BY THE ENGINEER.
 8. SEE CITY OF HOUSTON STANDARDS DWG NO: 01509-01 TO DWG NO: 01509-06 TYPICAL DIMENSIONS AND DETAILS.
 9. REFER COH STANDARD DWG NO: 01510-05 FOR STRIPING DETAILS (SHEET 266A).

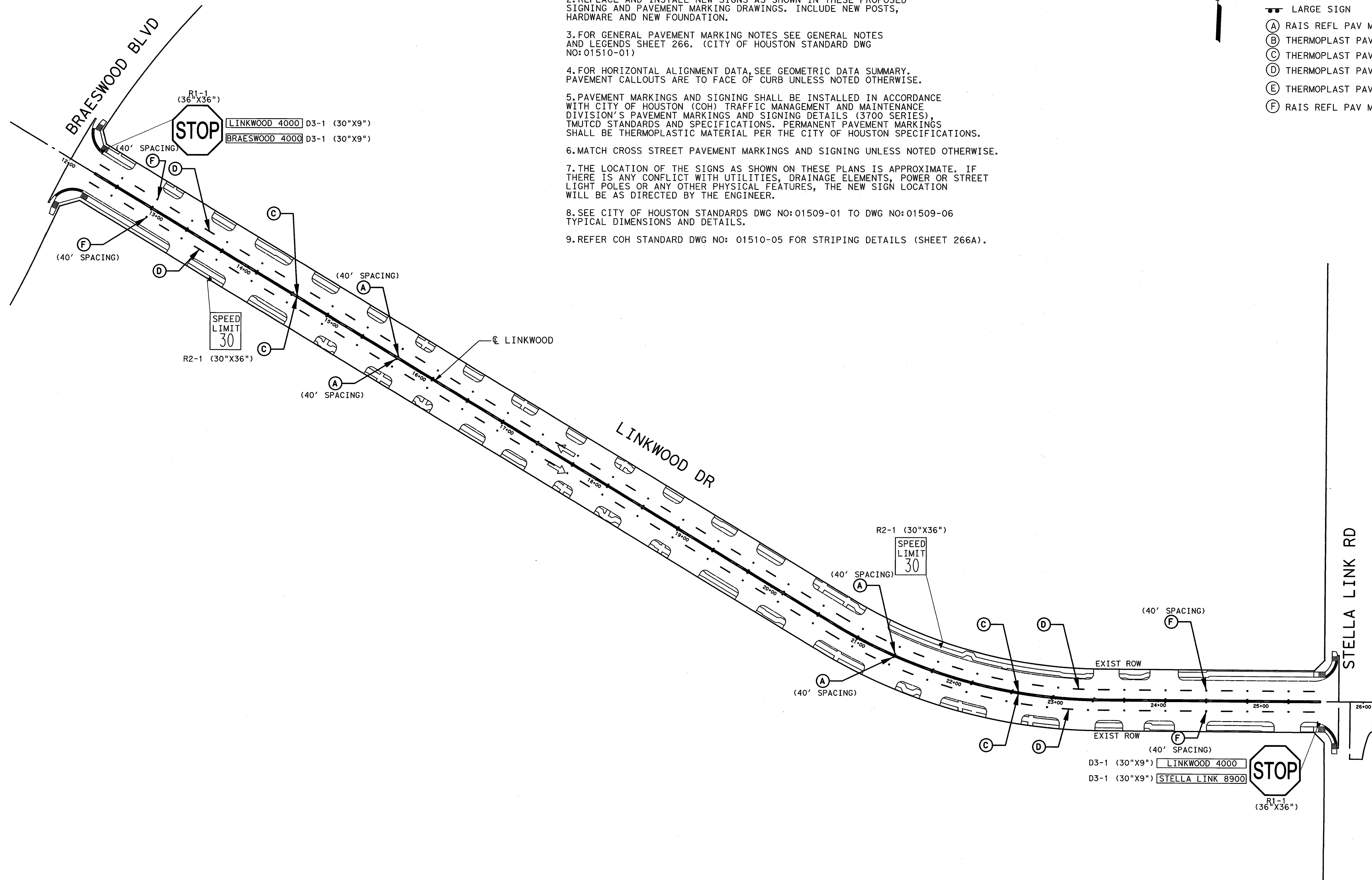

 TYPE REC NO. 2742 3131 BRIARPARK, SUITE 200 Houston, Texas 77042 Phone (713) 622-1444 Fax (713) 968-9333	

CITY OF HOUSTON
HOUSTON PUBLIC WORKS

**WOODSHIRE DRAINAGE
AND PAVING IMPROVEMENTS
SUBPROJECT 2**

**SIGNING AND PAVEMENT
MARKING LAYOUT
SHEET 4 OF 4**

WBS NUMBER	FOR CITY OF HOUSTON USE ONLY
M-410001-0002-4	
DRAWING SCALE	
1"=50'	
CITY OF HOUSTON PM	65779 CITY PLANNING DEPARTMENT
TIM VU, P.E.	
SHEET NO. 198 OF 355	

DATE: 12/16/2019 9:45:45 AM
 R:\002000-002699\002292005 Dwg\98\0 DRAINPHASE 2 Subproj\ref 2\Sheet\2292_P42_SIGN08.dgn